

"ALLIS STREET FLATS CONDOMINIUM"

A CONDOMINIUM IN THE SOUTHEAST 1/4 OF THE
SOUTHWEST 1/4 OF SECTION 4, TOWN 6 NORTH, RANGE 22 EAST,
IN THE CITY OF MILWAUKEE, MILWAUKEE COUNTY, WISCONSIN.

S. ALLIS STREET



REVISED MARCH 10, 2006

E. LINCOLN AVENUE

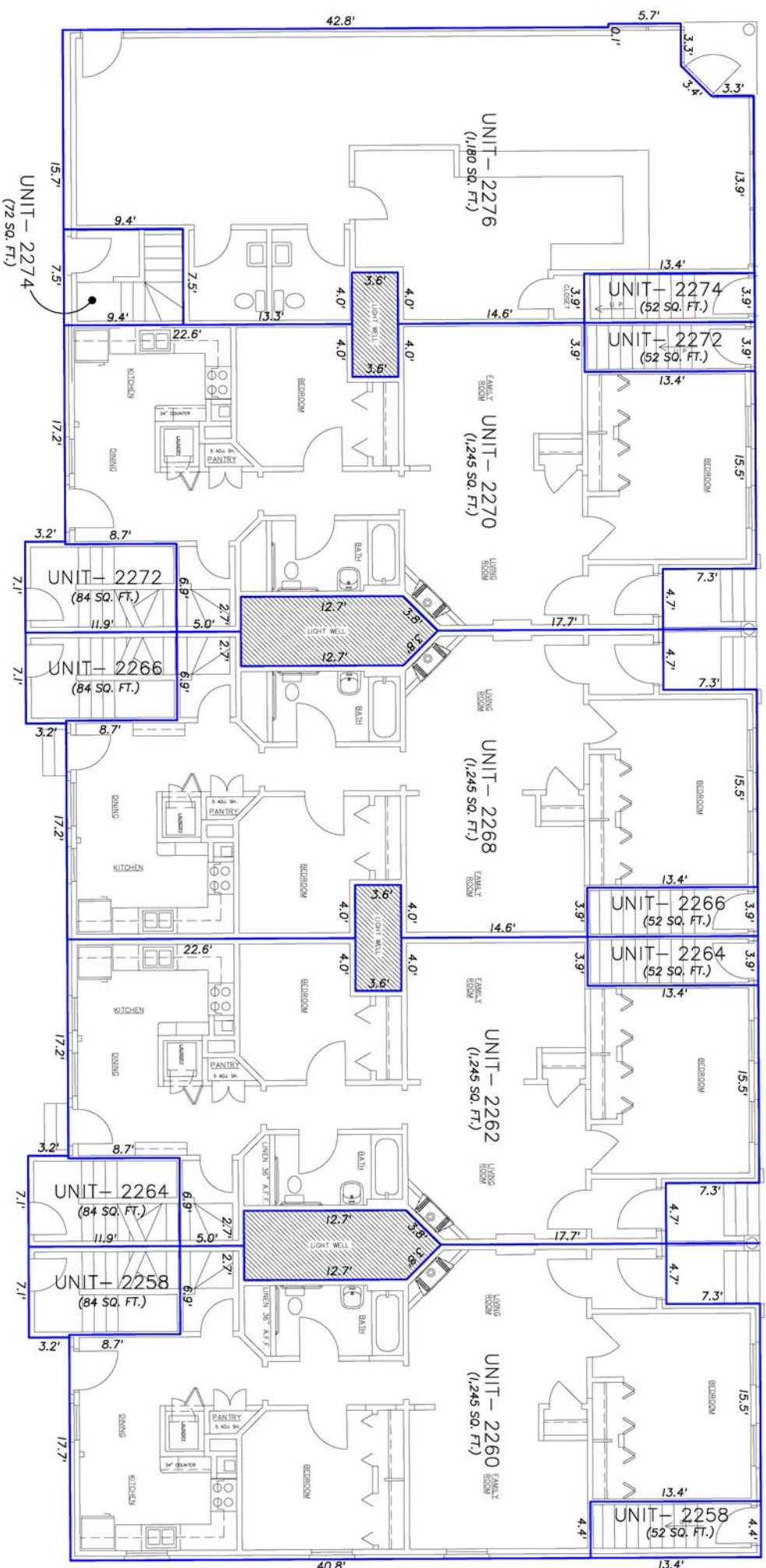

SURVEY CERTIFICATE

I have surveyed the above described property and the above map is a true representation thereof and shows the size and location of the property, its exterior boundaries, the location and dimensions of all visible structures thereon, boundary fences, apparent easements, roadways, and visible encroachments, if any.

This condominium is a correct representation of "ALLIS STREET FLATS CONDOMINIUM" and the identification and location of each unit, and to the extent feasible the common elements can be determined from this plat. The diagrammatic outline shows only the approximate dimensions, areas and location of each unit.

FIRST FLOOR

9-26-2005

James G. Schneider
Surveyor - S-2127

GRAPHIC SCALE

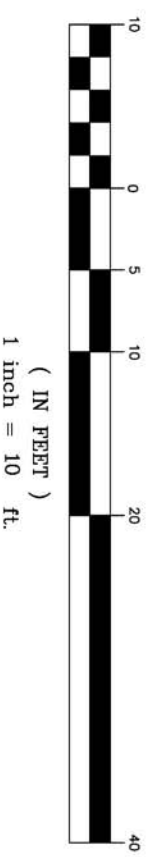

NORTH SHORE ENGINEERING, INC.
Consulting Engineers & Land Surveyors
11433 N. Port Washington Rd., Mequon, Wisconsin, 53092
(262) 241-9400 • FAX: (262) 241-5337