

# "ALLIS STREET FLATS CONDOMINIUM"

A CONDOMINIUM IN THE SOUTHEAST 1/4 OF THE  
SOUTHWEST 1/4 OF SECTION 4, TOWN 6 NORTH, RANGE 22 EAST,  
IN THE CITY OF MILWAUKEE, MILWAUKEE COUNTY, WISCONSIN.

**S. ALLIS STREET**



REVISED MARCH 10, 2006  
REVISED MARCH 8, 2006

**E. LINCOLN AVENUE**

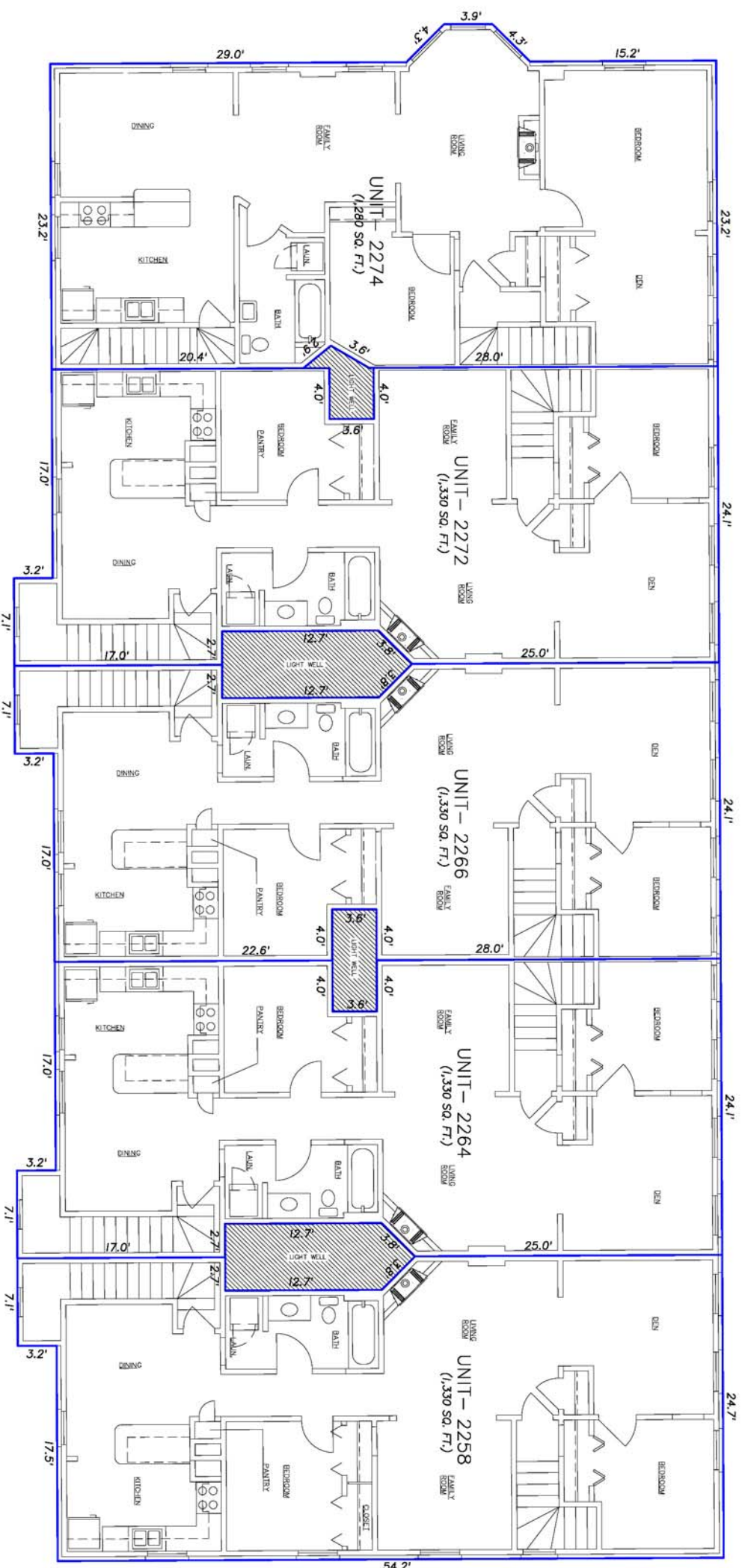

## SURVEY CERTIFICATE

I have surveyed the above described property and the above map is a true representation thereof and shows the size and location of the property, its exterior boundaries, the location and dimensions of all visible structures thereon, boundary fences, apparent easements, roadways, and visible encroachments, if any.

This condominium is a correct representation of "ALLIS STREET FLATS CONDOMINIUM" and the identification and location of each unit, and to the extent feasible the common elements can be determined from this plat. The diagrammatic outline shows only the approximate dimensions, areas and location of each unit.

## SECOND FLOOR

GRAPHIC SCALE



9-26-2005  
Date

James G. Schneider  
Surveyor - S-2127



**NORTH SHORE ENGINEERING, INC.**  
Consulting Engineers & Land Surveyors  
11433 N. Port Washington Rd., Mequon, Wisconsin, 53092  
(262) 241-9400 • FAX: (262) 241-5337